

ACACIA NARROWS RESERVE

MANAGEMENT PLAN

Resolution 1/91/373

ACACIA NARROWS RESERVE

APPROVED MANAGEMENT PLAN

This management plan was prepared by Mr D West, Planning Officer Reserves, Waipa District Council, in accordance with the requirements of Section 41 of the Reserves Act 1977.

This reserve has been classified in accordance with Section 17 of the Reserves Act 1977.

The Management Plan shall provide for and ensure the use, enjoyment, maintenance, protection and preservation, as the case may require, and, to the extent that the administering body's resources permit, the development, as appropriate, of the reserve for the purposes for which it is classified.

This Management Plan is designed to provide guidelines for future decisions made about the reserve. It will also give indications of appropriate uses in the reserve and how these should be regulated.

This is a certified copy of the final management plan adopted by resolution of the Waipa District Council at a meeting held on 18 November 1991.



Garry Dyet
DISTRICT PLANNER

578/10/1 Resolution

TABLE OF CONTENTS

	<u>PAGE NO.</u>
INTRODUCTION	3
Location and Access	3
Legal Description & Classification	3
History	3
Topography	3
Reserve Usage	6
Current Situation	6
Regional Significance	7
MANAGEMENT OBJECTIVES AND POLICIES	9
Major Management Objectives	9
Contributing Objectives	9
Objective 1 - Public Access	9
Objective 2 - Reserve Usage	10
Objective 3 - Vegetation Management	10
Objective 4 - Essential Services	12
Objective 5 - Building on the Reserve	12
Objective 6 - Signage	12
Map One - Locality Map	13
Map Two - Tenure	14
Map Three - Reserve Map	15

1 INTRODUCTION

1.1 **Location & Access**

Acacia Narrows Reserve is located on Airport Road, Rukuhia, approximately 400 metres upstream from the Narrows bridge on the western bank of the Waikato River.

The reserve is situated approximately five kilometres south east of Hamilton and fourteen kilometres west of Cambridge (see Map One).

Access to the reserve is gained via a fenced gravel carpark adjoining Airport Road.

1.2 **Legal Description & Classification**

Acacia Narrows Reserve has an area of 0.5480 hectares being described as Lot 2 DPS 36432 Block VII Hamilton Survey District (see Map Two).

The reserve is classified a recreation reserve pursuant to the Reserves Act 1977, Section 17 of the principle Act, and pursuant to the 1979 No. 63 Amendment to the Act Clause 5(c):

"The classification proposed is a condition subject to which the land was acquired for reserve purposes".

The land surrounding Acacia Narrows Reserve is zoned Rural B, and has adjoining landuses of agriculture and rural residential.

1.3 **History**

Accessibility to the reserves narrow sandy beach area adjoining the Waikato River means that the area described as Acacia Narrows reserve has over the years become very popular with the public for picnics, swimming, launching river craft while occasionally the river boat Waipa Delta lands at this beach area. The land however has been in private ownership until relatively recently.

Council's acquisition of this reserve dates back to 1984 when the surrounding land was subdivided with the reserve (Lot 2) being vested in the Waipa County Council in return for an esplanade reserve being officially waived along the adjoining lot.

1.4 **Topography**

The gentle sloping topography of the site means that Acacia Narrows Reserve is, along with the Narrows Recreation Reserve (situated adjacent to the Narrows bridge on the eastern bank of the Waikato River), one of the few public places suitable for river access in this vicinity.

The reserve topography generally consists of two distinct grassed terraces which are differentiated by a steep bank - up to eight metres high and vertical in places.

The larger, upper terrace has a gentle rolling contour which gradually slopes towards the Waikato River, but which is bound by the steep bank on its eastern edge.



"Upper Terrace"



"Lower Terrace"

The smaller, lower terrace being almost at river level is defined on its western side by the steep bank, while the Waikato River defines the eastern side. While this terrace is relatively narrow, there is a small beach area adjacent to it from which river craft are often launched.



"Narrow beach area"

River access is achieved via a sandy path sloping towards the river situated at the southern end of the reserve.



"River access path"

1.5 Reserve Usage

To date, the area of land comprising Acacia Narrows Reserve has been used predominantly for summer outdoor river related activities. As such the reserve has tended to be used by a specialised group of recreationists (i.e. river users) at specific times of the year (i.e. from November through April).

1.6 Current Situation

Acacia Narrows Reserve is currently in a semi developed state. A gravel car parking area capable of accommodating cars and buses has been developed in the north western corner of the reserve at road level.



"Formed car park"

However, vehicle access onto the reserve is currently possible via an unlocked gate situated at the car park. Foot access can be made via a fence stile.



"Gateway and fence stile"

The reserve vegetation consists predominantly of grass on the terraces with some established pseudo-Acacia trees (*Robinia*) growing along the banks and lower terrace.

The river access path sloping down to the lower terrace does not have a formed surface, as it has been cut into the steep bank of sandy soil with no provision for stormwater runoff. As such, the path has begun to erode while Acacia fronds are sprouting through it, giving the path an overgrown look.

No recreational facilities have been constructed on the reserve to date. However, three young silk trees (*Albizia julibrissin*) have been planted recently on the upper terrace and have been made stock proof (see Map Three).

1.7 Regional Significance

Acacia Narrows Reserve is the northern most recreational reserve of the eight located on the Waikato River and administered by Waipa District Council. Its current role is to provide an area for passive recreation and river access to the public.

Waikato District Council administer the Narrows Recreation Reserve which is situated only 400 metres downstream from Acacia Narrows on the opposite side of the Waikato River. This reserve performs a very similar role to Acacia Narrows and receives good usage. However, the Narrows Recreation Reserve is presently designated as a proposed motorway and it is likely that the reserve will be taken for this purpose at some time in the future. Once the Narrows Recreation Reserve has lost its role as a recreational reserve, this will place more pressure on Acacia Narrows Reserve to accommodate the extra usage and traffic load.

The following management objectives and policies have therefore taken this into account to produce a management philosophy of a similar nature to the one currently managing the Narrows Recreational Reserve.

2 MANAGEMENT OBJECTIVES AND POLICIES

The management objectives are derived partly from the Reserves Act 1977 and partly from Council Policy.

The objectives are guidelines for implementing the management plan and will set out the general purpose of the reserve and uses considered appropriate for the reserve.

Policies are of a more specific nature and are intended to show how management objectives can be achieved. They are derived from submissions received from the public, current Council policy and consultation with various people in specialist fields. Policies are tailored to fit the circumstances of Acacia Narrows Reserve.

2.1 Major Management Objective

To manage Acacia Narrows Reserve for passive recreation and the physical welfare and enjoyment of the public with emphasis on preserving the natural character of the area while ensuring public access to the Waikato River is maintained.

2.2 Contributing Objectives

2.2.1 Objective 1 - Public Access

To allow the public safe, uninhibited access onto the reserve and river bank from both Airport Road and the Waikato River.

Policies

- a. Fences and boundaries shall be located in a manner which define the reserve, exclude or contain stock and minimise disruption to users.
- b. Motor vehicles will be excluded from using the reserve other than within properly formed and maintained parking areas.
- c. Any fencing on the reserve must include access points of a standard suitable for reserve users to negotiate.
- d. The reserves vegetation shall be maintained at all times to a suitable level which allows public access to all parts of the reserve.
- e. The foreshore area shall be kept free from flotsam material and adventitious growth such that access from the Waikato River onto the reserve shall be maintained suitable for pleasure and other craft.

Explanation

The reserve, being in a semi-developed state has many obstacles to potential users. In order to encourage reserve usage, public access must be developed and maintained to a standard suitable for all reserve users.

2.2.2 Objective 2 - Reserve Usage

To encourage the use of this reserve for passive recreation activities.

Policies

- a. Overnight camping shall not be permitted on the reserve.
- b. Picnicking facilities should be provided for use by the public.
- c. Should public demand demonstrate the need, a barbecue facility should be provided for use by the public.
- d. The design, materials, and location of any public facilities should minimise opportunities for vandalism to occur.
- e. Fires should be permitted only in the barbecue facility provided and appropriate signs to this effect posted.
- f. The siting of these facilities shall have regard to the sun, shelter from the wind, proximity to burnable materials and be in clear view of reserve users.
- g. Swimming should be prohibited with the erection of a sign informing the public of the danger.

Explanation

Being well grassed and treed, the site is ideal for passive uses. As such the development of management policies and provision of recreational facilities should reflect the passive recreational function of the reserve. However, the narrow width of the Waikato River at this point makes swimming potentially dangerous and therefore this activity should be discouraged.

2.2.3 Objective 3 - Vegetation Management

To manage vegetation levels and types in order to preserve the reserves rural landscape character, enhance the intrinsic values of local ecosystems, while maintaining public access onto and throughout the reserve.

Policies

- a. To develop, install and maintain a landscape plan which identifies, delineates and promotes the reserve as a public reserve of natural beauty.
- b. The boundary of the reserve should be suitably planted so as to delineate it from surrounding properties while providing screening for the neighbouring rural residential inhabitants.
- c. There should be a good balance between planted areas, and areas of open space while taking into account the function of the reserve.
- d. Species planted should reflect the positive features of existing plantings, and in particular the character of the reserves rural landscape.
- e. Selective trees and other vegetation should be maintained in order to allow pedestrian access onto and throughout the reserve.
- f. Where appropriate the vegetation should be protected from damage by both humans and stock.
- g. All due consideration shall be given to soil conservation measures reflecting the reserves dual roles (i.e. passive recreation and stock grazing) in vegetation management.
- h. Class B noxious plants should be eradicated from the reserve.
- i. Maintenance of grass outside the peak use season shall utilise low impact stock where no threat to trees or facilities occurs.
- j. A grazing lease pursuant to Section 54 of the Reserves Act 1977, to graze the reserve during the off peak visitor season shall be offered to interested property owners.
- k. Any leasing agreement shall contain provisions guaranteeing public access onto the reserve as well as provisions for the control of noxious pests and plants.
- l. Grass cover in the peak season (November to April) should be managed through conventional means.

Explanation

Vegetation management policies are essential for preserving public access, maintaining a tidy reserve consistent with its rural character while minimising damage caused by human users and stock.

2.2.4 Objective 4 - Essential Services

To provide a minimum level of essential services to reserve users.

Policies

- a. The provision of waste receptacles shall be adequate enough to cater for the needs of all reserve users.

2.2.5 Objective 5 - Building on the Reserve

To minimise any visual impact that built structures would have on the natural character of the reserve.

Policies

- a. Only those built structures which have been demonstrated as being necessary for the enjoyment of passive recreation are permitted onto the reserve.
- b. The construction of any structure on the reserve shall utilise low impact materials, and where possible utilise materials indigenous to the area.

Explanation

Given the reserves size and nature, any built structure would tend to dominate the visual appearance of the reserve.

2.2.6 Objective 6 - Signage

To use signposts to inform and educate the public about the reserve, its usage, any inherent dangers and points of interest.

Policies

- a. Provide an information sign indicating the reserves status, the administering authority, permitted use and a contact number for further information.
- b. Provide a sign informing the public of the dangers of swimming in the Waikato River.
- c. All signs should be similar in style, utilise materials appropriate to the rural surrounding while being pursuant to the relevant sections of the operative District Scheme.

Explanation

While some signs are essential all signs on the reserve need to be controlled in order to minimise any visual intrusion they may make on the rural landscape quality.

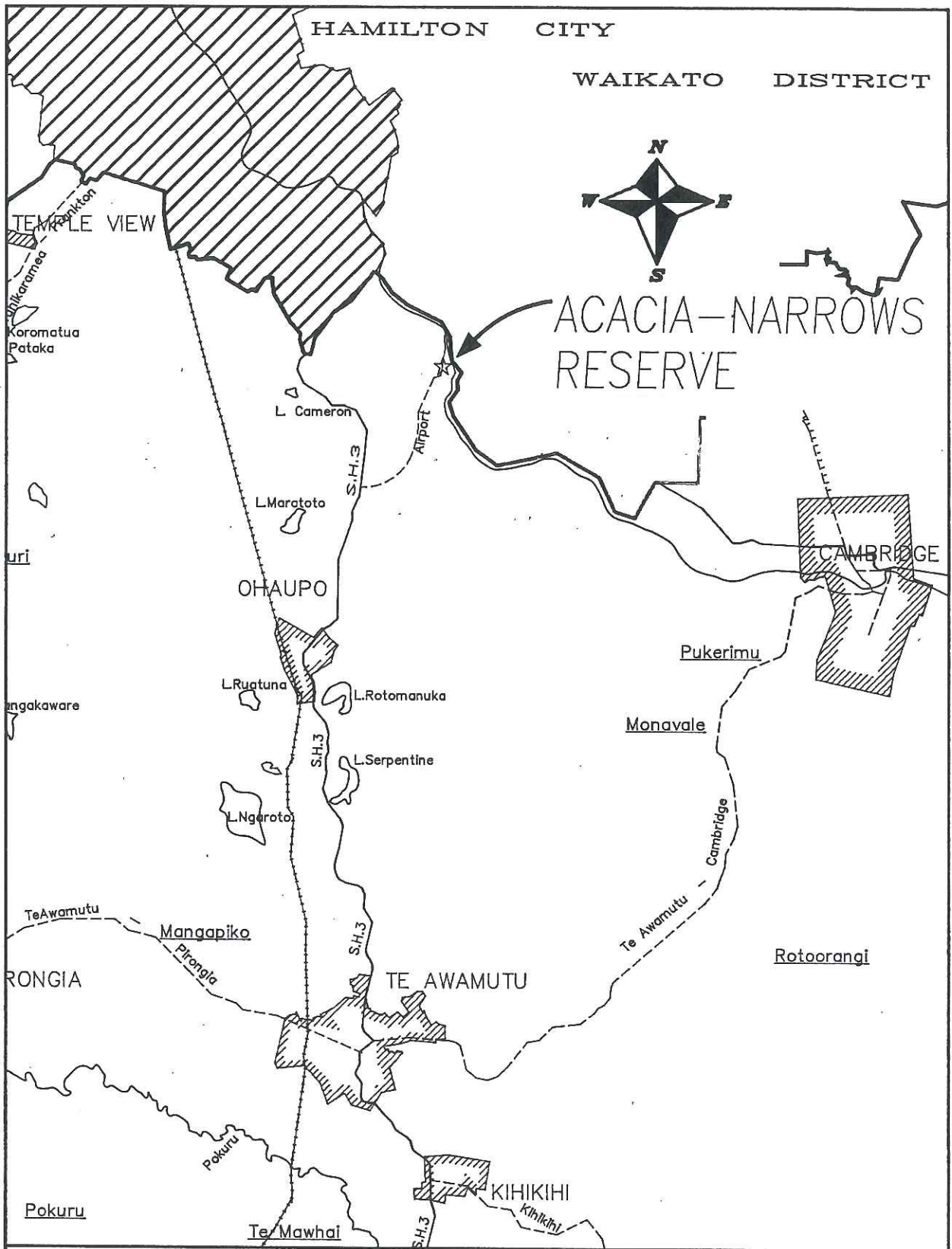

ACACIA-NARROWS RESERVE MANAGEMENT PLAN		MAP 1
LOCALITY MAP	SCALE: 1:150 000 DATE: 26/06/91 DRAWN: C.PARLANE	

Map Two

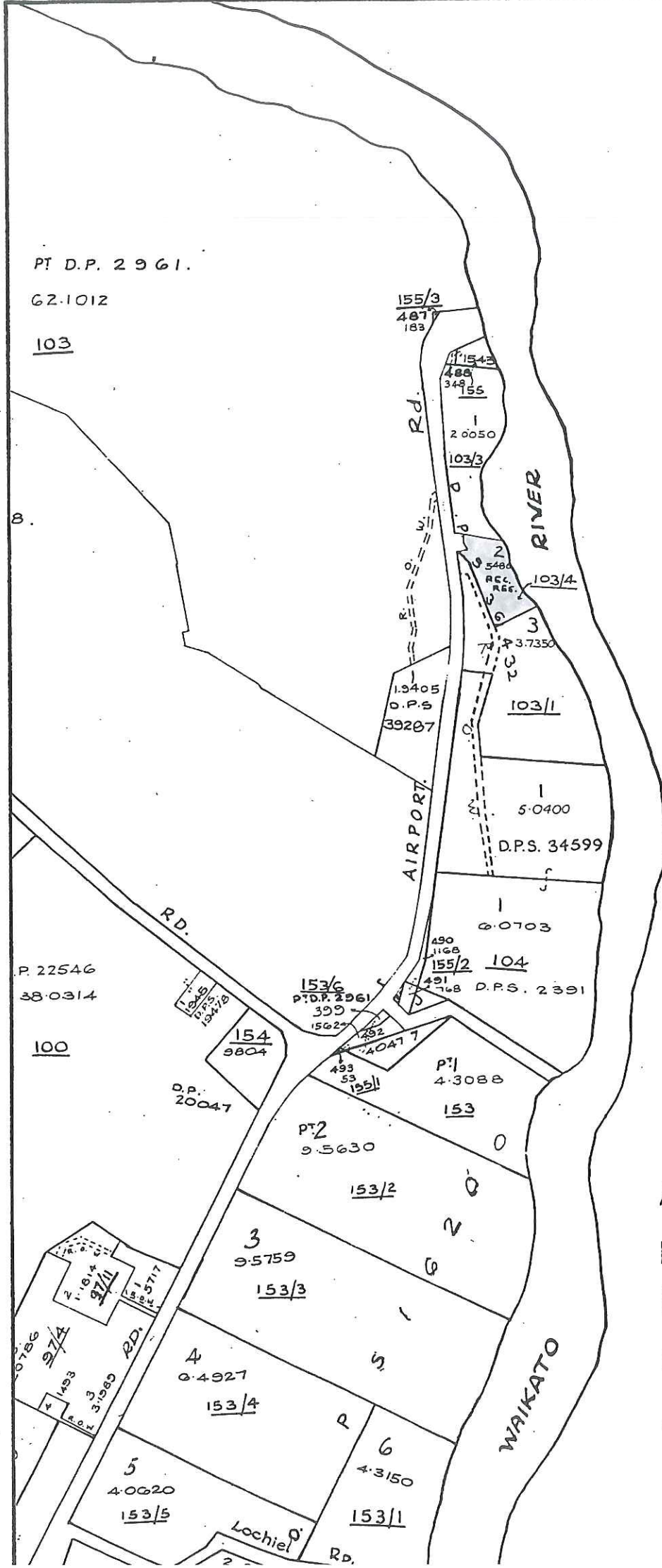

PT D.P. 2961.

62.1012

103

8.

P. 22546
38.0314

100

154
9804

D.P. 20047

153/6
P.D.P. 2961
399
15625

153/1
40477

153
4.3088

PT 2
9.5630

153/2

3
9.5759

153/3

4
0.4927

153/4

5
4.0620

153/5

Lochiel Rd.

153/1

155/3
4877
183

155/1
488
348
155

1
2.0050

103/3

2
5.480
REC. RES.

103/4

3
3.7350

103/1

1
1.3405
O.P.S.
39287

1
5.0400

D.P.S. 34599

1
0.0703

104
490
1168
491
768 D.P.S. 2391

WAIKATO RIVER

Acacia-Narrows Reserve
Lot 2 DPS 36432,
Block VII,
Hamilton Survey Dist.
Area: 0.5480 ha.

Map Three

Acacia Narrows Reserve

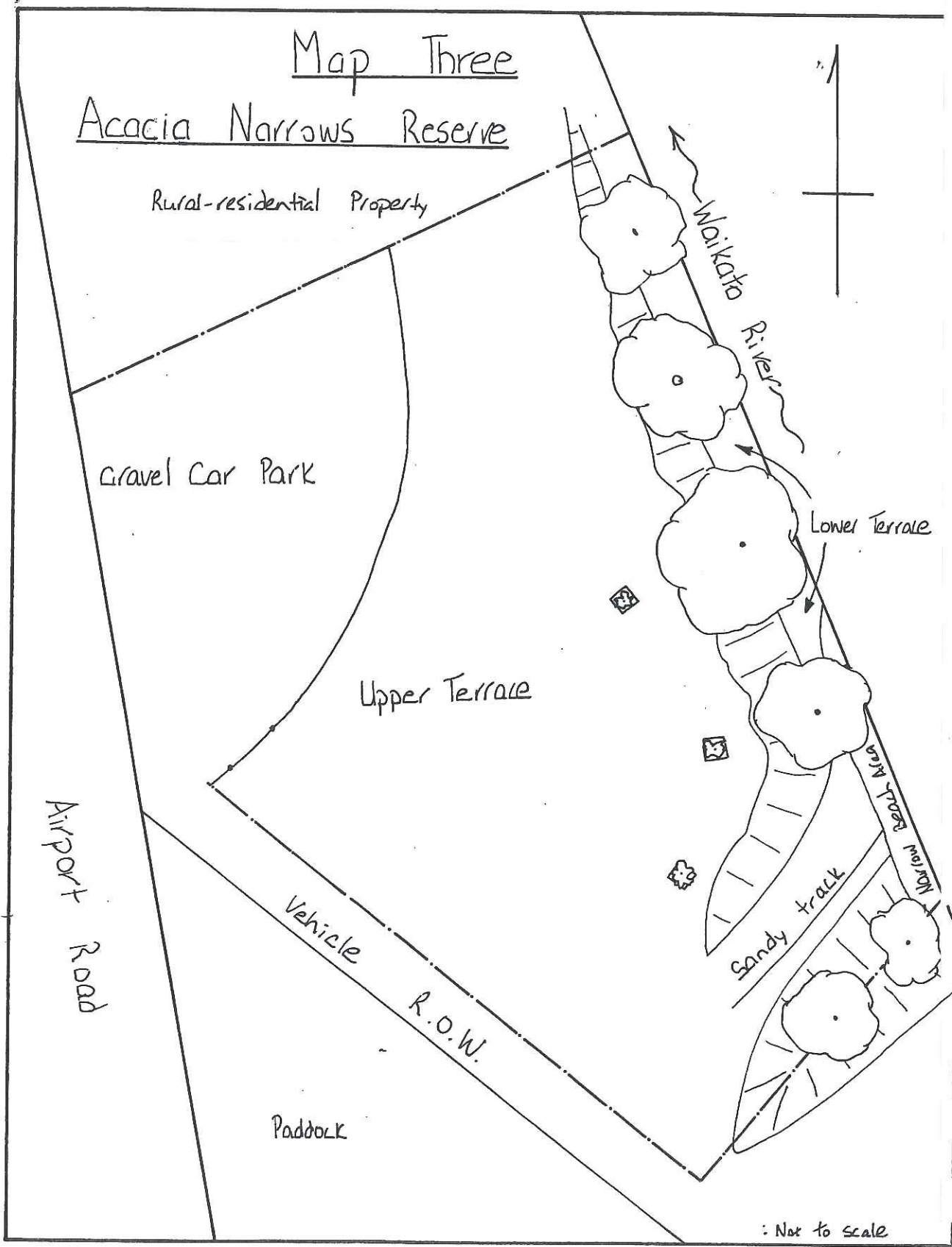

: Not to scale