

TREES IMAGES

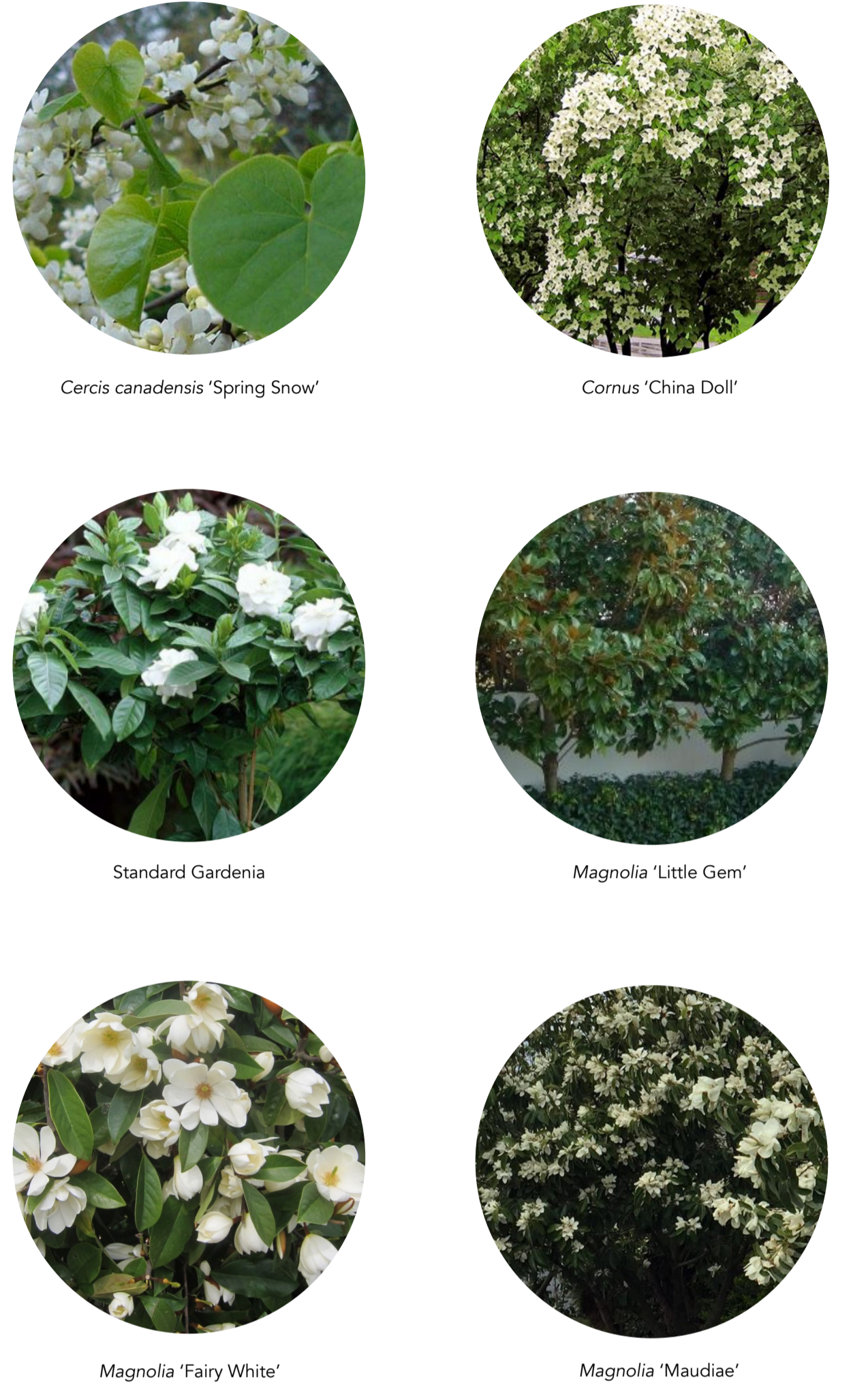

TREES - PLANT SCHEDULE

BOTANICAL NAME	QTY	BAG SIZE	NOTES
<i>Cercis canadensis</i> 'Spring Snow'	2	PB95	
<i>Cornus</i> 'China Doll'	1	PB95	
<i>Standard Gardenia</i>	3	PB95	Maintain round shape
<i>Magnolia</i> 'Little Gem'	9	PB95	2400mm spacings
<i>Magnolia</i> 'Fairy White'	1	PB95	
<i>Magnolia</i> 'Maudiae'	1	PB95	
<i>Prunus lusitanica</i>	12	PB95	1500mm spacings. 2m high pleached hedge.
<i>Pyrus calleryana</i> 'Candelabra'	3	PB95	2000mm spacings

SHRUBS - PLANT SCHEDULE

BOTANICAL NAME	QTY	BAG SIZE	NOTES
<i>Camellia</i> 'Early Pearly'	89	2L	600m spacings
<i>Liriope</i> 'Monroe White'	20	2L	500mm spacings
<i>Lomandra</i> 'White Sands'	50	2L	800mm spacings
<i>Trachelospermum jasminoides</i>	77	2L	700mm spacings
<i>Ophiopogon japonicus</i>	27	2L	400mm spacings



Additional Planting Notes:
 Planting should take place between 1st April and 30th September (Unless a water system is in place)

SHRUBS IMAGES



LYNLEY FIFE
 [mb] 027 293 0351
 [p] 07 827 3898
 [e] lynley@lineanddesign.co.nz
 [w] www.lineanddesign.co.nz

DWG NAME Planting Plan	
CLIENT Wendy & Warren Hodges	NO.
ADDRESS 109 Taylor Street, Cambridge	
DRAWN BY HT	SHEET 1
SCALE 1:100 @ A1	DATE 21.9.21

Contractors to check all dimensions, levels and council by-laws etc. prior to any construction. IF IN DOUBT, ASK



